

# Bundling and Securing

## Heavy Duty Cable Tie Mounts

### Mounts Secured with Mechanical Fasteners - Single Bundles

#### Heavy Duty Mounts - High Torque

The high-torque mount is designed for use with power-assisted impact wrenches and is molded with a heavy bushing to withstand the forces required to tighten grade 8 bolts. The arched H-profile of the saddle surface allows for a broad surface contact with the bundle, minimizing pinching and crushing of the bundles, and adjusts to a wide variety of bundle diameters when used with HellermannTyton heavy duty T120, T250, T255 and Wide Strap Cable Ties.

#### Features and Benefits

- Mount and tie combination makes it easy to service bundles in the field.
- Made from impact modified, heat stabilized, UV resistant material, ideal for heavy duty environments.
- Eliminates the need for multiple size fixed-diameter clamps.

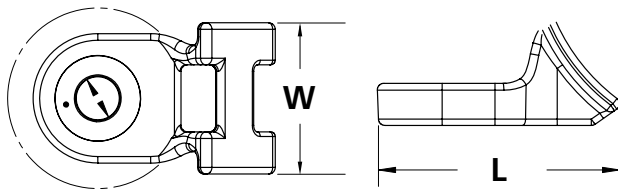

PART NO.	TYPE	Cable Tie Width Max. (G) in. (mm)	Mounting Screw Type	Max. Torque lbf-ft. (kgf-cm)	Length (L) in. (mm)	Width (W) in. (mm)	Material	Color	Pkg. Qty.
151-02098	HDM320	0.5 (12.7)	5/16" (M8) Screw	114.0 (1,576.0)	1.9 (47.0)	1.0 (25.0)	PA66HIRHSUV	Black	100
151-02094		0.5 (12.7)	5/16" (M8) Screw	114.0 (1,576.0)	1.9 (47.0)	1.0 (25.0)	PA66HIRHSUV	Black	500
151-02097	HDM500	0.5 (12.7)	1/2" (M12) Screw	114.0 (1,576.0)	1.9 (47.0)	1.0 (25.0)	PA66HIRHSUV	Black	100
151-02096		0.5 (12.7)	1/2" (M12) Screw	114.0 (1,576.0)	1.9 (47.0)	1.0 (25.0)	PA66HIRHSUV	Black	500

Dimensions are approximate and subject to technical changes. Use Part No. for ordering and Type for specification purposes.